

EX CABLE GLANDS

FOR HAZARDOUS AREAS
ATEX & IECEX

Zones 1, 2, 21 and 22



CABLE GLANDS EX D/E ATEX	4
CABLE GLANDS UNARMoured EX D IP66 - IP68	5
CABLE GLANDS UNARMoured EX E IP66 - IP68	5
CABLE GLANDS UNARMoured EX D/E IP66 - IP68	6
CABLE GLANDS ARMoured EX D/E IP66 - IP68	7
DOUBLE COMPRESSION CABLE GLANDS ARMoured EX D/E IP66 - IP68	8
BARRIER CABLE GLANDS UNARMoured CABLE EX D IP66 - IP68	9
BARRIER CABLE GLANDS ARMoured CABLE EX D IP66 - IP68	11
CABLE GLANDS POLYAMIDE EX/E IP68	13
CABLE GLANDS ATEX INCREASED SECURITY POLYAMIDE EX/I IP68	14
STOPPER PLUG EX D/E IP66 - IP68	15
PLUG EX D/E IP66 - IP68	16
PLUG POLYAMIDE EX/E IP66	17
ADAPTER I EX D/E IP66 - IP68	18
ADAPTER EX D/E IP66 - IP68	19
REDUCER EX D/E IP66 - IP68	20
ENLARGER - REDUCER EX D/E IP66 - IP68	21
AUTOMATIC BREATHER AND DRAINAGE HAZARDOUS AREA VALVES ATEX IP66	22
SHROUD IP66 - IP68	23
EARTH TAG	23

Delvalle, wide experience in manufacturing solutions for hazardous area



WE PUT AT YOUR DISPOSAL

We offer over **45 years** providing hazardous area **solutions** to demanding customers who require very specific characteristics and behaviour according to the sector and their needs.

WHEREVER YOU GO

We are committed to working closely with our customers, providing them with exceptional service and offering an advanced and **extensive range of hazardous area products** with very competitive prices.

CONSULTING & ENGINEERING

Atex Delvalle adapts to our clients' needs by offering hazardous-area systems.
Certified Junction Box Assembly.
Atex-delvalle are the leading certified assembler of Ex junction boxes. With an extensive stock holding of stainless steel enclosures, our workshops are able to provide unrivalled competence, expertise, quality and service to customer specifications.
Our customized services, experienced design and drafting 3D support.

HIGH STANDARD OF QUALITY AND SERVICES

We only use materials provided by companies who offer the very highest quality, suitable and certified products. Our success is due to **top quality** assurance:
ISO 9001, SGS, UL, TÜV, ISO 14000, Ohsas 18001, ATEX, IECEx.



CONTACT US

Confidentiality, reliability & quality

www.atexdelvalle.com
atex@atexdelvalle.com
+34 945 601 381

ALSO ONLINE

Please contact our technical sales department.

A team of professionals with high experience and ability to solve all your queries.





Zones 1, 2, 21 and 22

CABLE GLANDS EX D/E

ATEX



Examples

The Most Powerful Security

Cable glands ATEX made by AtexDelvalle are used for passing, holding and compressing cables between two compartments, such as junction boxes, cabinets, electrical boxes or devices requiring sealing against dust, dirt or water.

➔ [FOR MORE INFORMATION CLICK HERE](#)



CABLE GLANDS UNARMOURED IP66 - IP68

CABLE GLANDS UNARMOURED EX D / EX E IP66 - IP68



- Material:
 - Nickel-plated brass brass*
 - Stainless steel AISI303L**
 - Stainless steel AISI304L**
 - Stainless steel AISI316L**
- O-ring: NBR or silicone (optional)
- Normative and marking:
 - II 2G Exd/e IIC Gb II ID Ex ta IIC Da I M2 Exd/e I Mb
 - EN 60079-0:2009, 60079-1:2007, 60079-31:2009
- Protection class: IP66 / IP68 (EN 60529)
- Application area:
 - Zones 1, 2, 21 and 22
 - Group Gas IIA, IIB and IIC

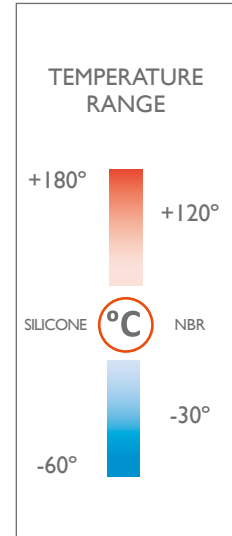

Reference configuration. Examples: MCNAE.MI6.SI.S6 or MCNAD.NI-1/4.NB.S4

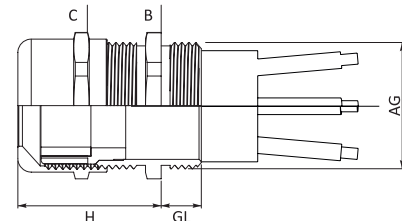
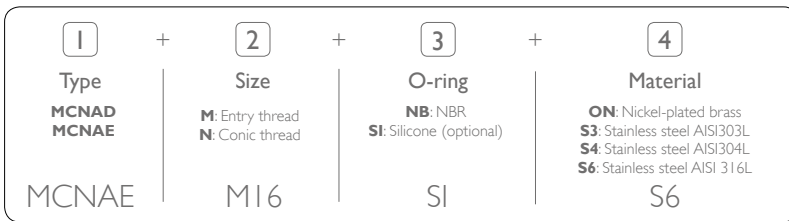

REFERENCES CABLE GLANDS UNARMOURED EX D / EX E									
CABLE GLANDS UNARMOURED EX D / EX E	SIZE	ENTRY THREAD ISO 262 (AG)	CONIC THREAD NPT (AG)	CLAMPING RANGE (mm)		GL (mm)	⚙️ (mm)		MINIMUM
				MIN.	MAX.		B	C	
MCNAD	M12 - NI/4	M12x1,5	1/4"	3	6,5	15	14	14	50* 25**
MCNAD	M16 - N3/8	M16x1,5	3/8"	4	8	15	18	17	
MCNAD	M20 - NI/2	M20x1,5	1/2"	6	12	15	22	22	
MCNAD	M25S - N3/4S	M25Sx1,5	3/4"	10	14	15	27	24	
MCNAD	M25 - N3/4	M25x1,5	3/4"	13	18	15	30	30	
MCNAD	M32 - NI	M32x1,5	1"	13	18	15	34	30	25* 10**
MCNAD	M40 - NI-1/4	M40x1,5	1 1/4"	18	25	15	43	40	
MCNAD	M50 - NI-1/2	M50x1,5	1 1/2"	22	32	15	55	50	
MCNAD	M63S - N2S	M63Sx1,5	2"	33	44	15	68	64	
MCNAD	M63 - N2	M63x1,5	2"	45	55	15	70	75	
MCNAD	M75S - N2-1/2S	M75Sx1,5	2 1/2"	45	55	15	85	75	10* 5**
MCNAD	M75 - N2-1/2	M75x1,5	2 1/2"	50	63	20	90	90	
MCNAD	M80 - N3S	M80x2	3"	50	63	20	90	90	
MCNAD	M90 - N3	M90x2	3"	60	70	20	100	100	
MCNAE	M12 - NI/4	M12x1,5	1/4"	3	6,5	6	14	14	
MCNAE	M16 - N3/8	M16x1,5	3/8"	4	8	7	18	17	
MCNAE	M20 - NI/2	M20x1,5	1/2"	6	12	8	22	22	
MCNAE	M25S - N3/4S	M25Sx1,5	3/4"	10	14	8	27	24	
MCNAE	M25 - N3/4	M25x1,5	3/4"	13	18	8	30	30	
MCNAE	M32 - NI	M32x1,5	1"	13	18	9	34	30	25* 10**
MCNAE	M40 - NI-1/4	M40x1,5	1 1/4"	18	25	9	43	40	
MCNAE	M50 - NI-1/2	M50x1,5	1 1/2"	22	32	9	55	50	
MCNAE	M63S - N2S	M63Sx1,5	2"	33	44	14	68	64	
MCNAE	M63 - N2	M63x1,5	2"	45	55	15	70	75	
MCNAE	M75S - N2-1/2S	M75Sx1,5	2 1/2"	45	55	15	85	75	10* 5**
MCNAE	M75 - N2-1/2	M75x1,5	2 1/2"	50	63	20	90	90	
MCNAE	M80 - N3S	M80x2	3"	50	63	20	90	90	
MCNAE	M90 - N3	M90x2	3"	60	70	20	100	100	

* Nickel-plated brass

** Stainless steel AISI303L - Stainless steel AISI304L - Stainless steel AISI316L

CABLE GLANDS EX D/E

CABLE GLANDS UNARMOURED EX D/E IP66 - IP68



- Material:
 - Nickel-plated brass*
 - Stainless steel AISI303L**
 - Stainless steel AISI304L**
 - Stainless steel AISI316L**
- O-ring: NBR or silicone (optional)
- Normative and marking:
 - II 2G Exd/e IIC Gb II ID Ex ta IIIC Da I M2 Exd/e I Mb
 - EN 60079-0:2009, 60079-1:2007, 60079-31:2009
- Protection class: IP66 / IP68 (EN 60529)
- Application area:
 - Zones 1, 2, 21 and 22
 - Group Gas IIA, IIB and IIC

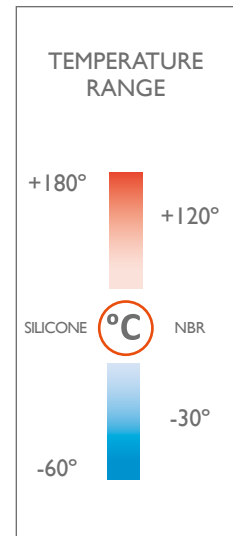

Reference configuration. Examples: MCNA.MI6.SI.S6 or MCNA.NI/2S.NB.ON

1	+	2	+	3	+	4
Type MCNA		Size M: Entry thread N: Conic thread		O-ring NB: NBR SI: Silicone (optional)		Material ON: Nickel-plated brass S3: Stainless steel AISI303L S4: Stainless steel AISI304L S6: Stainless steel AISI 316L
MCNA		MI6		SI		S6

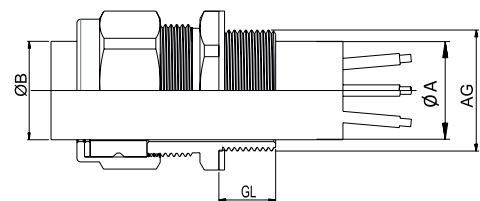

REFERENCES CABLE GLANDS UNARMOURED EX D/E

CABLE GLANDS UNARMOURED EX D/E	SIZE	ENTRY THREAD ISO 262 (AG)	CONIC THREADS NPT (AG)	B		GL (MIN. mm)	(mm)		MINIMUM
				MIN.	MAX.		C	B	
MCNA	M16 - NI/2S	M16x1,5	1/2"	6,1	11,6	15	20	24	50* 25**
MCNA	M20 - NI/2	M20x1,5	1/2"	9,5	15,9	15	24	24	
MCNA	M25 - N3/4	M25x1,5	3/4"	12,5	20,5	15	30	30	
MCNA	M32 - NI	M32x1,5	1"	18,2	26,2	15	38	38	25* 10**
MCNA	M40 - NI 1/4	M40x1,5	1 1/4"	23,7	33,9	15	45	45	
MCNA	M50 - NI 1/2	M50x1,5	1 1/2"	27,9	40,4	15	55	55	
MCNA	M63S - N2	M63Sx1,5	2"	40,4	51	15	70	70	
MCNA	M63 - N21/2	M63x1,5	2 1/2"	47,2	55,9	15	70	80	10* 5**
MCNA	M75S - N21/2S	M75Sx1,5	2 1/2"	52,8	59	15	80	80	
MCNA	M75 - N3	M75x1,5	3"	59,1	67,9	15	90	100	

* Nickel-plated brass

** Stainless steel AISI303L - Stainless steel AISI304L - Stainless steel AISI316L

CABLE GLANDS ARMoured EX D/E IP66 - IP68

CABLE GLANDS ARMoured EX D/E IP66 - IP68



- Material:
 - Nickel-plated brass*
 - Stainless steel AISI303L**
 - Stainless steel AISI304L**
 - Stainless steel AISI316L**
- O-ring: NBR or silicone (optional)
- Normative and marking:
 - II 2G Exd/e IIC Gb II 1D Ex ta IIIC Da I M2 Exd/e I Mb
 - EN 60079-0:2009, 60079-1:2007, 60079-31:2009
- Protection class: IP66 / IP68 (EN 60529)
- Application area:
 - Zones 1, 2, 21 and 22
 - Group Gas IIA, IIB and IIC

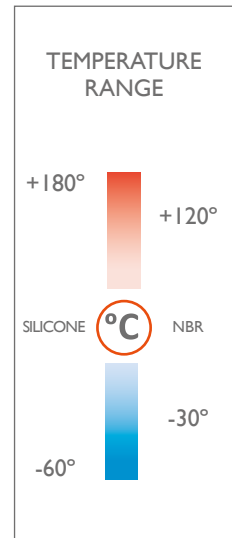

Reference configuration. Examples: MVCGA1.M16.SI.S6 or MVCGA1.N3/4.NB.ON

1	+	2	+	3	+	4
Type		Size		O-ring		Material
MVCGA1		M: Entry thread N: Conic thread		NB: NBR SI: Silicone (optional)		ON: Nickel-plated brass S3: Stainless steel AISI303L S4: Stainless steel AISI304L S6: Stainless steel AISI 316L
MVCGA1		M16		SI		S6

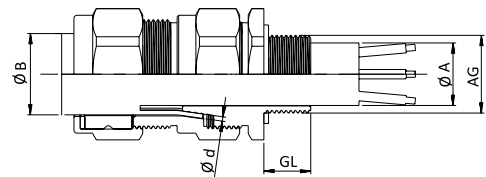

REFERENCES CABLE GLANDS ARMoured EX D/E											
CABLE GLANDS ARMoured EX D/E	SIZE	ENTRY THREAD ISO 262 (AG)	CONIC THREADS NPT (AG)	A (MIN.)	B		Ø D		GL (mm)	Wrench (mm)	MINIMUM
					MIN.	MAX.	MIN.	MAX.			
MVCGA1	M16 - NI/2SS	M16x1,5	1/2"	8,6	6,1	13,2	0,8	1,0	15	24	50* 25**
MVCGA1	M20S - NI/2S	M20x1,5	1/2"	11,6	9,5	15,9	0,8	1,25	15	24	
MVCGA1	M20 - NI/2	M20x1,5	1/2"	13,9	12,5	20,9	0,8	1,25	15	30	
MVCGA1	M25S - N3/4S	M25x1,5	3/4"	19,9	14	22	1,25	1,60	15	38	
MVCGA1	M25 - N3/4	M25x1,5	3/4"	19,9	18,2	26,2	1,25	1,60	15	38	
MVCGA1	M32 - NI	M32x1,5	1"	26,2	23,7	33,9	1,6	2,0	15	45	25* 10**
MVCGA1	M40 - NI 1/4	M40x1,5	1 1/4"	33,9	27,9	40,4	1,6	2,0	15	55	
MVCGA1	M50S - NI 1/2	M50x1,5	1 1/2"	38,1	35,2	46,7	2,0	2,5	15	60	
MVCGA1	M50 - N2S	M50x1,5	2"	44,0	40,4	53,1	2,0	2,5	15	70	
MVCGA1	M63S - N2	M63x1,5	2"	49,9	45,6	59,4	2,0	2,5	15	75	
MVCGA1	M63 - N21/2S	M63x1,5	2 1/2"	55,9	54,6	65,9	2,0	2,5	15	80	10* 5**
MVCGA1	M75S - N21/2	M75x1,5	2 1/2"	61,9	59	72,1	2,0	2,5	15	90	
MVCGA1	M75 - N3S	M75x1,5	3"	67,9	66,7	78,5	2,5	3,0	15	100	
MVCGA1	M90 - N3	M90x2,0	3"	79,9	76,2	90,4	3,0	3,5	15	115	
MVCGA1	M100	M100x2,0	-	90	86,1	101,5	3,15	4,0	15	123	
MVCGA1	M115	M115x2,0	-	97,9	101,5	110,3	3,15	4,0	15	133	
MVCGA1	M130	M130x2,0	-	114,9	114,2	123,3	3,15	4,0	15	146	

* Nickel-plated brass

** Stainless steel AISI303L - Stainless steel AISI304L - Stainless steel AISI316L

DOUBLE COMPRESSION CABLE GLANDS ARMoured EX D/E IP66 - IP68



- Material:
 - Nickel-plated brass*
 - Stainless steel AISI303L**
 - Stainless steel AISI304L**
 - Stainless steel AISI316L**
- O-ring: NBR or silicone (optional)
- Normative and marking:
 - II 2G Exd/e IIC Gb II ID Ex ta IIIC Da I M2 Exd/e I Mb
 - EN 60079-0:2009, 60079-1:2007, 60079-31:2009
- Protection class: IP66 / IP68 (EN 60529)
- Application area:
 - Zones 1, 2, 21 and 22
 - Group Gas IIA, IIB and IIC

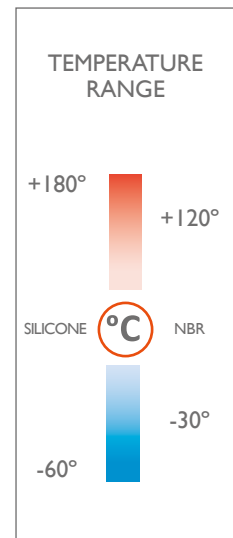

Reference configuration. Examples: MVCGA2.M16.SI.S6 or MVCGA2.NI1/2.NB.S3

1	+	2	+	3	+	4
Type		Size		O-ring		Material
MVCGA2		M : Entry thread N : Conic thread		NB : NBR SI : Silicone (optional)		ON : Nickel-plated brass S3 : Stainless steel AISI303L S4 : Stainless steel AISI304L S6 : Stainless steel AISI 316L
MVCGA2		M16		SI		S6

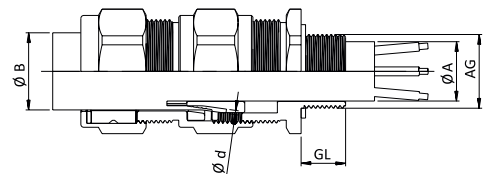

REFERENCES DOUBLE COMPRESSION CABLE GLANDS ARMoured EX D/E													
DOUBLE COMPRESSION CABLE GLANDS ARMoured EX D/E	SIZE	ENTRY THREAD ISO 262 (AG)	CONIC THREADS NPT (AG)	A		B		Ø D		GL (mm)	GL (mm)	MINIMUM	
				MIN.	MAX.	MIN.	MAX.	MIN.	MAX.				
MVCGA2	M16 - NI/2SS	M16x1,5	1/2"	3,1	8,6	6,1	13,2	0,8	1,0	15	24	50* 25**	
MVCGA2	M20S - NI/2S	M20Sx1,5	1/2"	6,1	11,6	9,5	15,9	0,8	1,25	15	24		
MVCGA2	M20 - NI/2	M20x1,5	1/2"	6,5	13,9	12,5	20,9	0,8	1,25	15	30		
MVCGA2	M25S - N3/4S	M25Sx1,5	3/4"	11,1	19,9	14	22	1,25	1,60	15	38		
MVCGA2	M25 - N3/4	M25x1,5	3/4"	11,1	19,9	18,2	26,2	1,25	1,60	15	38		
MVCGA2	M32 - NI	M32x1,5	1"	18,2	26,2	23,7	33,9	1,6	2,0	15	45	25* 10**	
MVCGA2	M40 - NI1/4	M40x1,5	1 1/4"	23,7	33,9	27,9	40,4	1,6	2,0	15	55		
MVCGA2	M50S - NI1/2	M50Sx1,5	1 1/2"	29,5	38,1	35,2	46,7	2,0	2,5	15	60		
MVCGA2	M50 - N2S	M50x1,5	2"	35,6	44,0	40,4	53,1	2,0	2,5	15	70		
MVCGA2	M63S - N2	M63Sx1,5	2"	40,1	49,9	45,6	59,4	2,0	2,5	15	75		
MVCGA2	M63 - N21/2S	M63x1,5	2 1/2"	47,2	55,9	54,6	65,9	2,0	2,5	15	80	10* 5**	
MVCGA2	M75S - N21/2	M75Sx1,5	2 1/2"	52,8	61,9	59	72,1	2,0	2,5	15	90		
MVCGA2	M75 - N3S	M75x1,5	3"	59,1	67,9	66,7	78,5	2,5	3,0	15	100		
MVCGA2	M90 - N3	M90x2,0	3"	66,6	79,9	76,2	90,4	3,0	3,5	15	115		
MVCGA2	M100	M100x2,0	-	76	90	86,1	101,5	3,15	4,0	15	123		
MVCGA2	M115	M115x2,0	-	86	97,9	101,5	110,3	3,15	4,0	15	133	10* 5**	
MVCGA2	M130	M130x2,0	-	97	114,9	114,2	123,3	3,15	4,0	15	146		

* Nickel-plated brass

** Stainless steel AISI303L - Stainless steel AISI304L - Stainless steel AISI316L

BARRIER CABLE GLANDS UNARMoured CABLE IP66 - IP68

BARRIER CABLE GLANDS UNARMoured CABLE EX D IP66 - IP68

- Flameproof Ex d barrier cable glands sealed with sealing compound
- The sealing ring seals and blocks cable on the outer sheath
- Kit version includes complete series of the rubber seals accompanying the size
- Material:
 - Nickel-plated brass
 - Stainless steel AISI316L
- O-ring: EPDM or Silicone (optional)
- Marking:
 - Ex e II Ex d IIC Ex tD
 - Ex e I Ex d I
 - I Exd IICx/2Exe IIX
- Protection class: IP66 - IP68
- Group II, category 2D, presence of combustible dust, zones 21 and 22
- Group II, category 2G, explosive gas atmosphere, zones 1 and 2
- Mine: Group I, category M2

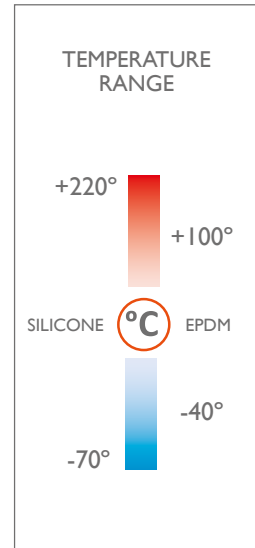

COMPOUND APPLICATION / BARRIER

The treatment is composed by bi-syringe containing the two resin components, separated and already dosed for the mixing, which occurs when the components pass inside the mixer.





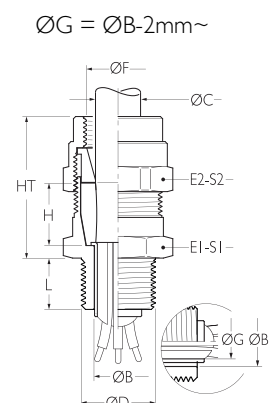

Available upon request solid compound, this epoxy resin is offered in two separate parts, it dries in 4 hours and can be installation any orientation.

Reference configuration. Examples: MBCNA.MI6.KIT.EP.S6 or MBCNA.G2I/2.KIT.SI.ON

1	+	2	+	3	+	4	+	5
Type		Code		Kit		O-ring		Material
MBCNA		M: ISO 262 G: ISO 228 PG: DIN 40430 NPT: NPT R: EN 10226		KIT		EP: EPDM SI: Silicone (optional)		ON: Nickel-plated brass S6: Stainless steel AISI 316L
MBCNA		MI6		KIT		EP		S6



BARRIER CABLE GLANDS UNARMoured CABLE EX D IP66 - IP68

TYPE	SIZE	DIMENSIONS Ø MIN-MAX	CYLINDRICAL THREADS			CONIC THREADS		WEIGHT	ØF	HT	H																	
			ISO 262	ISO 228	DIN 40430	NPT	EN 10226																					
MBCNA	16 (EP)	4 - 7	M12x1,5 M16x1,5 M20x1,5	1/4" 3/8" 1/2"	PG7 PG9 PG11 PG13,5	1/4" 3/8" 1/2"	1/4" 3/8" 1/2"	94	16	38	20	24	26	24	26													
MBCNA		7 - 10																										
MBCNA	16 (SI)	4 - 6																										
MBCNA		6 - 8																										
MBCNA		8 - 10																										
MBCNA		5,5 - 8																										
MBCNA	20 (EP-SI)	8 - 10,5														M16x1,5 M20x1,5 M25x1,5	1/2" 3/4"	PG11 PG13,5 PG16	1/2" 3/4"	1/2" 3/4"	156	20	40	20	30	33	32	35
MBCNA		10,5 - 13																										
MBCNA		8 - 10,5																										
MBCNA	25 (EP-SI)	10,5 - 13														M20x1,5 M25x1,5	3/4" 1"	PG16 PG21	3/4" 1"	3/4" 1"	185	25	40	20	35	38	36	39
MBCNA		13 - 15,5																										
MBCNA		15,5 - 18																										
MBCNA		13 - 15,5																										
MBCNA	32 (EP-SI)	15 - 18	M25x1,5 M32x1,5	1"	PG21 PG29	1"	1"	340	32	52	25	42	47	45	49													
MBCNA		18 - 21																										
MBCNA		21 - 24																										
MBCNA		21 - 24																										
MBCNA	40 (EP-SI)	24 - 27	M40x1,5	1 1/4"	PG29	1 1/4"	1 1/4"	421	38	52	25	48	53	50	55													
MBCNA		27 - 30																										
MBCNA		24 - 27																										
MBCNA	50 (EP-SI)	27 - 30	M40x1,5 M50x1,5	1 1/2"	PG36	1 1/2"	1 1/2"	537	44	52	25	55	60	57	62													
MBCNA		30 - 33																										
MBCNA		33 - 36																										
MBCNA		36 - 39																										
MBCNA	63 (EP-SI)	39 - 42	M50x1,5 M63x1,5	2"	PG42 PG48	2"	2"	749	54	52	25	68	74	67	72													
MBCNA		42 - 45																										
MBCNA		45 - 48																										
MBCNA	75 (EP-SI)	48 - 51	M63x1,5 M75x1,5	2 1/2"	PG48	2 1/2"	2 1/2"	1085	65	52	25	80	86	80	88													
MBCNA		51 - 54																										
MBCNA		54 - 58																										
MBCNA	90a (EP-SI)	58 - 62	M75x1,5 M90x2	3"	/	3"	3"	2125	74	67	30	100	107	100	107													
MBCNA		60 - 64																										
MBCNA	90b (EP-SI)	64 - 68																										
MBCNA		64 - 68																										

Available upon request

BARRIER CABLE GLANDS ARMoured CABLE IP66 - IP68

BARRIER CABLE GLANDS ARMoured CABLE EX D IP66 - IP68



- Flameproof Ex d barrier cable glands sealed with sealing compound
- The sealing ring seals and blocks cable on the outer sheath
- Kit version includes complete series of the rubber seals accompanying the size
- Material:
 - Nickel-plated brass
 - Stainless steel AISI316L
- O-ring: EPDM or Silicone (optional)
- Marking:
 - Ex e II Ex d IIC Ex tD
 - Ex e I Ex d I
 - I Ex d IICx/2Exe IIX
- Protection class: IP66 - IP68
- Group II, category 2D, presence of combustible dust, zones 21 and 22
- Group II, category 2G, explosive gas atmosphere, zones 1 and 2
- Mine: Group I, category M2

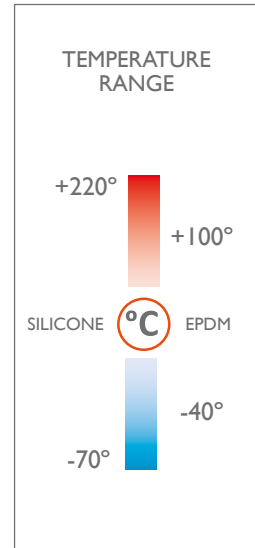

COMPOUND APPLICATION / BARRIER

The treatment is composed by bi-syringe containing the two resin components, separated and already dosed for the mixing, which occurs when the components pass inside the mixer.





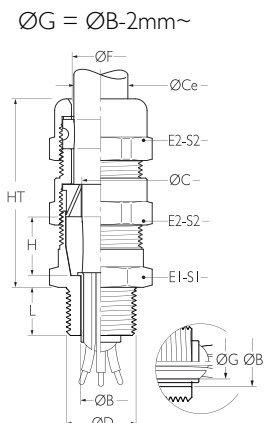

Available upon request solid compound, this epoxy resin is offered in two separate parts, it dries in 4 hours and can be installation any orientation.

Reference configuration. Examples: MBCA.MI6.KIT.EP.S6 or MBCA.G2I/2.KIT.SI.ON

1	+	2	+	3	+	4	+	5
Type		Code		Kit		O-ring		Material
MBCA		M: ISO 262 G: ISO 228 PG: DIN 40430 NPT: NPT R: EN 10226		KIT		EP: EPDM SI: Silicone (optional)		ON: Nickel-plated brass S6: Stainless steel AISI 316L
MBCA		MI6		KIT		EP		S6



BARRIER CABLE GLANDS ARMoured CABLE EX D IP66 - IP68

TYPE	SIZE	DIMENSIONS ØC MIN-MAX	DIMENSIONS ØCe MIN-MAX	CYLINDRICAL THREADS			CONIC THREADS		WEIGHT	ØF	HT	H				
				ISO 262	ISO 228	DIN 40430	NPT	ISO 75								
MBCA	16 (EP)	4 - 7	5 - 10 10 - 15	M12x1,5 M16x1,5 M20x1,5	1/4" 3/8" 1/2"	PG7 PG9 PG11 PG13,5	1/4" 3/8" 1/2"	1/4" 3/8" 1/2"	126	16	58	20	24	26	24	26
MBCA		7 - 10														
MBCA	16 (SI)	4 - 6														
MBCA		6 - 8														
MBCA		8 - 10														
MBCA	20 (EP-SI)	5,5 - 8														
MBCA		8 - 10,5														
MBCA		10,5 - 13														
MBCA	25 (EP-SI)	8 - 10,5	15 - 20 19 - 24	M20x1,5 M25x1,5	3/4" 1"	PG16 PG21	3/4" 1"	3/4" 1"	264	25	64	20	35	38	36	39
MBCA		10,5 - 13														
MBCA		13 - 15,5														
MBNA		15,5 - 18														
MBCA	32 (EP-SI)	13 - 15,5	20 - 26 25 - 31	M25x1,5 M32x1,5	1"	PG21 PG29	1"	1"	484	32	83	25	42	47	45	49
MBCA		15 - 18														
MBCA		18 - 21														
MBCA		21 - 24														
MBCA	40 (EP-SI)	21 - 24	26 - 32 31 - 37	M40x1,5	1 1/4"	PG29	1 1/4"	1 1/4"	576	38	83	25	48	53	50	55
MBCA		24 - 27														
MBCA		27 - 30														
MBCA	50 (EP-SI)	24 - 27	31 - 37 36 - 43	M40x1,5 M50x1,5	1 1/2"	PG36	1 1/2"	1 1/2"	730	44	83	25	55	60	57	62
MBCA		27 - 30														
MBCA		30 - 33														
MBCA		33 - 36														
MBCA	63 (EP-SI)	36 - 39	42 - 48 47 - 53	M50x1,5 M63x1,5	2"	PG42 PG48	2"	2"	961	54	83	25	68	74	67	72
MBCA		39 - 42														
MBCA		42 - 45														
MBCA	75 (EP-SI)	45 - 48	52 - 58 52 - 64	M63x1,5 M75x1,5	2 1/2"	PG48	2 1/2"	2 1/2"	1392	65	83	25	80	86	80	88
MBCA		48 - 51														
MBCA		51 - 54														
MBCA	90a (EP-SI)	54 - 58	64 - 72	M75x1,5 M90x2	3"	/	3"	3"	3026	74	115	30	100	107	100	107
MBCA		58 - 62														
MBCA	90b (EP-SI)	60 - 64	70 - 78													
MBCA		64 - 68														

Available upon request

CABLE GLANDS EX D/E

CABLE GLANDS POLYAMIDE

CABLE GLANDS POLYAMIDE EX/E IP68



- Material: Polyamide (Nylon) - UL 94V-2
- O-ring Silicone
- Features: V2 (UL94), halogen free, not containing any cadmium phosphorus, UV-resistance and anti-aging test
- Marking:
 - Ex e IIC Gb
 - Ex tD A21 IP68
- Protection class: IP68
- Application area:
 - Zones 1, 2, 21 and 22
 - Group Gas IIA, IIB and IIC

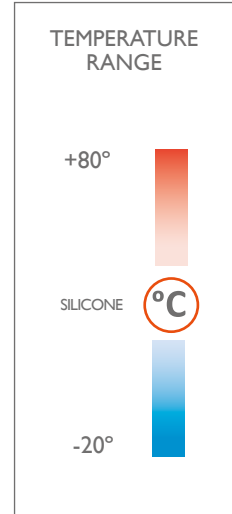

Reference configuration. Examples: MVCG.M16.EXE.NY or MVCG.M40.EXE.NY

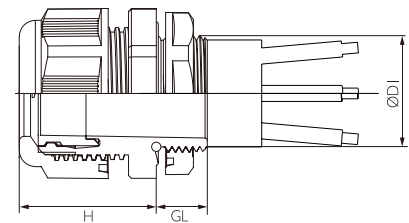

REFERENCES CABLE GLANDS POLYAMIDE EX/E

CABLE GLANDS POLYAMIDE EX/E	SIZE	ENTRY THREAD ISO 262	CLAMPING RANGE		H (mm)	GL (mm)	(mm)	MINIMUM
			≥	≤				
MVCG	M12	M12x1,5	3	6,5	21	8	15	50
MVCG	M16	M16x1,5	5	10	25	8	22	
MVCG	M20	M20x1,5	10	14	28	9	27	
MVCG	M25	M25x1,5	13	18	31	11	33	
MVCG	M32	M32x1,5	18	25	37	11	42	25
MVCG	M40	M40x1,5	22	32	48	13	53	
MVCG	M50	M50x1,5	32	38	49	13	60	10
MVCG	M63	M63x1,5	37	44	49	14	65 / 68	

CABLE GLANDS ATEX INCREASED SECURITY POLYAMIDE EX/I IP68



- Material: Polyamide (Nylon) - UL 94V-2
- O-ring Silicone
- Features: V2 (UL94), halogen free, not containing any cadmium phosphorus, UV-resistance and anti-aging test
- Normativa y marcaje:
 - Ex e IIC Gb
 - Ex tD A21 IP68
- Protection class: IP68
- Application area:
 - Zones 1, 2, 21 and 22
 - Group Gas IIA, IIB and IIC

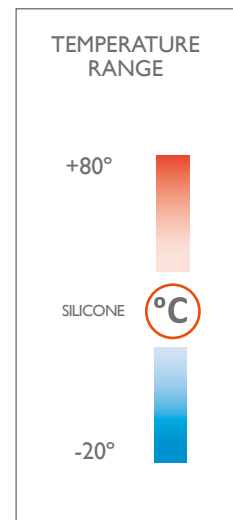

Reference configuration. Examples: MVCG.M16.EX.AZ.NY or MVCG.M40.EX.AZ.NY

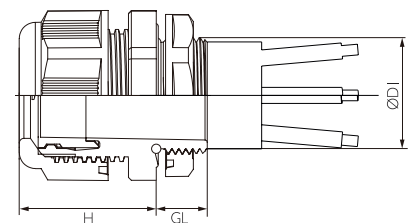
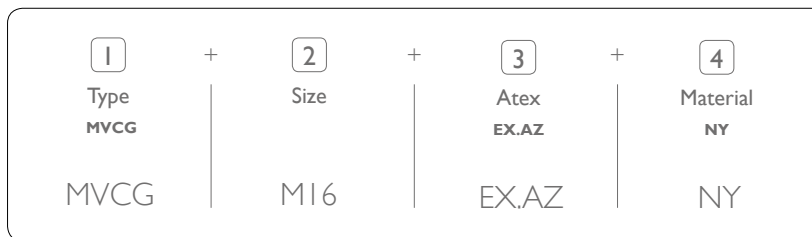

REFERENCES CABLE GLANDS POLYAMIDE EX/I

CABLE GLANDS POLYAMIDE EX/I	SIZE	ENTRY THREAD ISO 262	CLAMPING RANGE		H (mm)	GL (mm)	(mm)	MINIMUM
			≥	≤				
MVCG	M12	M12x1,5	3	6,5	21	8	15	50
MVCG	M16	M16x1,5	5	10	25	8	22	
MVCG	M20	M20x1,5	10	14	28	9	27	
MVCG	M25	M25x1,5	13	18	31	11	33	
MVCG	M32	M32x1,5	18	25	37	11	42	25
MVCG	M40	M40x1,5	22	32	48	13	53	
MVCG	M50	M50x1,5	32	38	49	13	60	10
MVCG	M63	M63x1,5	37	44	49	14	65 / 68	



PLUGS

STOPPER PLUG EX D/E IP66 - IP68



- Material:
 - Nickel-plated brass*
 - Stainless steel AISI303L**
 - Stainless steel AISI304L**
 - Stainless steel AISI316L**
- O-ring: NBR
- Normative and marking:
 - II 2G Exd/e IIC Gb II ID Ex ta IIIC Da I M2 Ex d/e I Mb
 - EN 60079-0 2009 /60079-1 2007/ 60079-31 2009
- Protection class: IP66 / IP68 (EN 60529)
- Application area:
 - Zones 1, 2, 21 and 22
 - Group Gas IIA, IIB and IIC

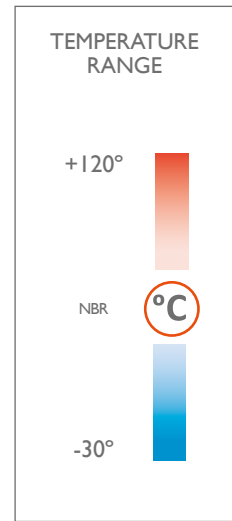

Reference configuration. Examples: MVTC.M16.S6.EX or MVTX.N21/2.ON

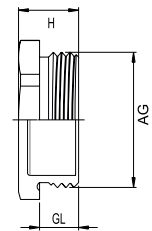
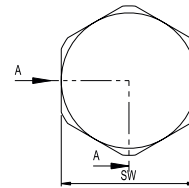
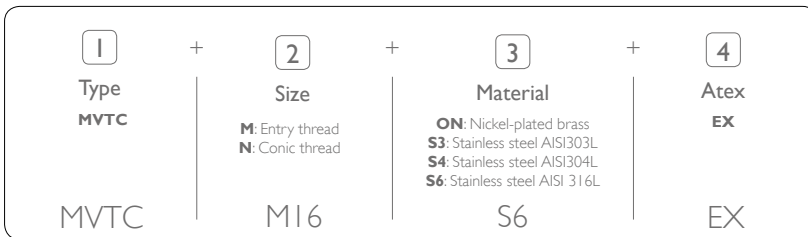

REFERENCES STOPPER PLUG						
STOPPER PLUG	CODE	SIZE	GL (MIN. mm)	H (mm)	SW (mm)	MINIMUM
MVTC	M12	M12x1,5	15	22	17	25* 10**
MVTC	M16	M16x1,5	15	22	22	
MVTC	M20	M20x1,5	15	22	24	
MVTC	M25	M25x1,5	15	22	30	
MVTC	M32	M32x1,5	15	22	36	10* 5**
MVTC	M40	M40x1,5	15	22	45	
MVTC	M50	M50x1,5	15	22	55	5* 1**
MVTC	M63	M63x1,5	15	22	70	
MVTC	M75	M75x1,5	15	22	80	
MVTC	M90	M90x2	20	27	95	
MVTC	M100	M100x2	20	27	110	
MVTC	N1/4	NPT1/4"	15	22	15	25* 10**
MVTC	N3/8	NPT3/8"	15	22	20	
MVTC	N1/2	NPT1/2"	15	22	24	
MVTC	N3/4	NPT3/4"	15	22	27	
MVTC	N1	NPT1"	15	22	35	10* 5**
MVTC	N1 1/4	NPT1 1/4"	15	22	45	
MVTC	N1 1/2	NPT1 1/2"	15	22	50	5* 1**
MVTC	N2	NPT2"	15	22	65	
MVTC	N2 1/2	NPT2 1/2"	20	27	75	
MVTC	N3	NPT3"	20	27	90	
MVTC	N4	NPT4"	20	27	115	

* Nickel-plated brass

** Stainless steel AISI303L - Stainless steel AISI304L - Stainless steel AISI316L

PLUG EX D/E IP66 - IP68



- Material:
 - Nickel-plated brass*
 - Stainless steel AISI303L**
 - Stainless steel AISI304L**
 - Stainless steel AISI316L**
- O-ring: NBR
- Normative and marking:
 - II 2G Exd/e IIC Gb II ID Ex ta IIIC Da I M2 Ex d/e I Mb
 - EN 60079-0 2009 /60079-1 2007/ 60079-31 2009
- Protection class: IP66 / IP68 (EN 60529)
- Application area:
 - Zones I, 2, 21 and 22
 - Group Gas IIA, IIB and IIC

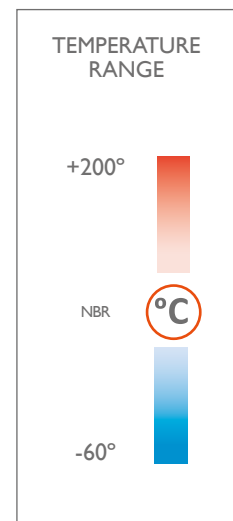

Reference configuration. Examples: MVT.S6.EX.M16 or MVT.ON.EX.NI 1/2

1	+	2	+	3	+	4
Type		Material		Atex		Size
MVT		ON: Nickel-plated brass S3: Stainless steel AISI303L S4: Stainless steel AISI304L S6: Stainless steel AISI 316L		EX		M: Entry thread N: Conic thread
MVT		S6		EX		M16

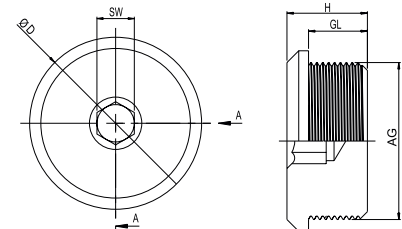

REFERENCES PLUGS EX D/E							
PLUG	CODE	SIZE	GL (MIN. mm)	H (mm)	D (mm)	SW (mm)	MINIMUM
MVT	M12	M12x1,5	15	21	17	6	25* 10**
MVT	M16	M16x1,5	15	21	22	8	
MVT	M20	M20x1,5	15	21	27	10	
MVT	M25	M25x1,5	15	21	30	10	
MVT	M32	M32x1,5	15	21	36	10	10* 5**
MVT	M40	M40x1,5	15	21	45	10	
MVT	M50	M50x1,5	15	21	55	10	5* 1**
MVT	M63	M63x1,5	15	21	68	10	
MVT	M75	M75x1,5	15	21	80	14	
MVT	M90	M90x2	20	26	95	14	
MVT	M100	M100x2	20	26	108	14	
MVT	NI1/4	NPT1/4"	15	21	19	6	25* 10**
MVT	N3/8	NPT3/8"	15	21	23	8	
MVT	NI1/2	NPT1/2"	15	21	27	10	
MVT	N3/4	NPT3/4"	15	21	32	10	
MVT	NI	NPT1"	15	21	39	10	10* 5**
MVT	NI 1/4	NPT1 1/4"	15	21	48	10	
MVT	NI 1/2	NPT1 1/2"	15	21	55	10	5* 1**
MVT	N2	NPT2"	15	21	65	10	
MVT	N2 1/2	NPT2 1/2"	20	26	78	14	
MVT	N3	NPT3"	20	26	95	14	
MVT	N4	NPT4"	20	26	120	14	

* Nickel-plated brass

** Stainless steel AISI303L - Stainless steel AISI304L - Stainless steel AISI316L

CABLE GLANDS EX D/E

PLUG POLYAMIDE EX/E IP66 - IP68



- Material: Polyamide (Nylon)
- O-ring: Silicone
- Features: water proof
- Normative and marking:
 - Ex eII Gb Ex tD A20
 - IEC - EN 60079
- Protection class: IP66
- Application area:
 - Zones 1, 2, 21 and 22
 - Group Gas IIA, IIB and IIC

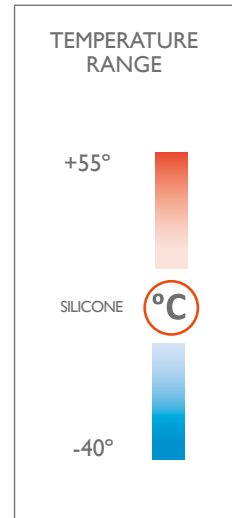

Reference configuration. Examples: DVT.EX.M16.NY or DVT.EX.M40.N

1	+	2	+	3	+	4
Type		Atex		Size		Material
DVT		EX		M16		NY

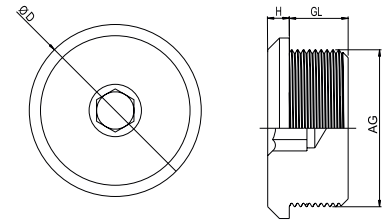

REFERENCES PLUG POLYAMIDE EX/E						
PLUG POLYAMIDE EX/E	SIZE	ENTRY THREAD ISO 262 (AG)	GL	H	ØD	MINIMUM
DVT	M16	M16x1,5	14	4	22	100
DVT	M20	M20x1,5	15	4	26,4	
DVT	M25	M25x1,5	15	4	31,9	
DVT	M32	M32x1,5	16	5,5	39,6	50
DVT	M40	M40x1,5	16	5,5	50,6	
DVT	M50	M50x1,5	16	5,5	60,5	25
DVT	M 63	M63x1,5	19	7,5	74,8	



ADAPTERS EX D/E IP66 - IP68

ADAPTER I EX D/E IP66 - IP68



- Material:
 - Nickel-plated brass
 - Stainless steel AISI303L**
 - Stainless steel AISI304L**
 - Stainless steel AISI316L**
- O-ring: NBR
- Normative and marking:
 - II 2G Exd/e IIC Gb II ID Ex ta IIIC Da I M2 Ex d/e I Mb
 - EN 60079-0 2009 /60079-1 2007/ 60079-31 2009
- Protection class: IP66 / IP68 (EN 60529)
- Application area:
 - Zones 1, 2, 21 and 22
 - Group Gas IIA, IIB and IIC

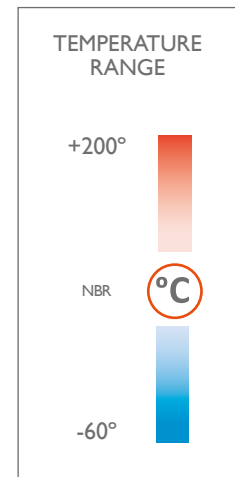

Reference configuration. Examples: MVADI.M40NI.S6 or MVADI.N3/8MI2.S4

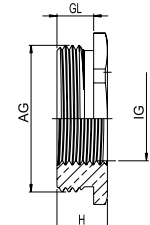
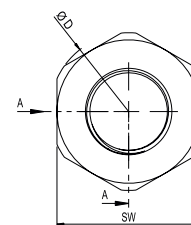
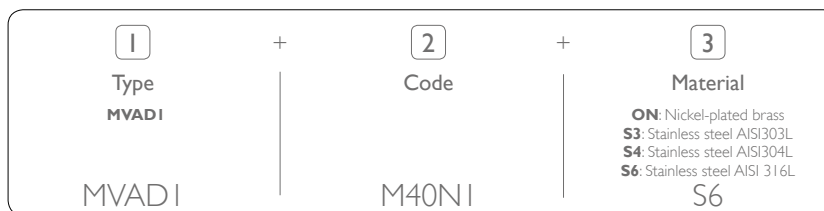

REFERENCES ADAPTER I EX D/E						
ADAPTER I	CODE	SIZE AG (M)	SIZE IG (F)	GL (MIN. mm)	H (mm)	SW (mm)
MVADI	M16NI1/4	M16x1,5	NPT1/4"	15	19	22
MVADI	M20NI1/4	M20x1,5	NPT1/4"	15	19	25
MVADI	M25NI1/2	M25x1,5	NPT1/2"	15	19	30
MVADI	M32NI1/2	M32x1,5	NPT1/2"	15	19	36
MVADI	M32N3/4	M32x1,5	NPT3/4"	15	19	36
MVADI	M40N3/4	M40x1,5	NPT3/4"	18	22	45
MVADI	M40NI	M40x1,5	NPT1"	18	22	45
MVADI	M50NI	M50x1,5	NPT1"	18	23	55
MVADI	M50NI 1/4	M50x1,5	NPT1 1/4"	18	23	55
MVADI	M63NI 1/4	M63x1,5	NPT1 1/4"	18	23	70
MVADI	M63NI 1/2	M63x1,5	NPT1 1/2"	18	23	70
MVADI	M75NI 1/2	M75x1,5	NPT1 1/2"	18	24	85
MVADI	M75N2	M75x1,5	NPT2"	18	24	85
MVADI	M90N2	M90x1,5	NPT2"	21	29	100
MVADI	M90N21/2	M90x1,5	NPT2 1/2"	21	29	100
MVADI	M110N21/2	M110x1,5	NPT2 1/2"	21	31	120
MVADI	M110N3	M110x1,5	NPT3"	21	31	120
MVADI	N3/8MM12	NPT3/8"	M12x1,5	15	19	22
MVADI	N1/2M12	NPT1/2"	M12x1,5	15	19	25
MVADI	N1/2M16	NPT1/2"	M16x1,5	15	19	25
MVADI	N3/4M16	NPT3/4"	M16x1,5	15	19	30
MVADI	N3/4M20	NPT3/4"	M20x1,5	15	19	30
MVADI	N1M20	NPT1"	M20x1,5	15	19	36
MVADI	N1M25	NPT1"	M25x1,5	15	19	36
MVADI	N1 1/4M25	NPT1 1/4"	M25x1,5	18	18	45
MVADI	N1 1/4M32	NPT1 1/4"	M32x1,5	18	18	45
MVADI	N1 1/2M32	NPT1 1/2"	M32x1,5	18	18	55
MVADI	N1 1/2M40	NPT1 1/2"	M40x1,5	18	18	55
MVADI	N2M40	NPT2"	M40x1,5	18	18	65
MVADI	N2M50	NPT2"	M50x1,5	18	18	65
MVADI	N21/2M50	NPT2 1/2"	M50x1,5	18	18	75
MVADI	N21/2M63	NPT2 1/2"	M63x1,5	18	18	75
MVADI	N3M63	NPT3"	M63x1,5	21	21	95
MVADI	N3M75	NPT3"	M75x1,5	21	21	95
MVADI	N4M75	NPT4"	M75x1,5	21	21	120
MVADI	N4M90	NPT4"	M90x1,5	21	21	120

Available upon request

ADAPTER EX D/E IP66 - IP68



- Material:
 - Nickel-plated brass
 - Stainless steel AISI303L**
 - Stainless steel AISI304L**
 - Stainless steel AISI316L**
- O-ring: NBR
- Normative and marking:
 - II 2G Exd/e IIC Gb II 1D Ex ta IIIC Da I M2 Ex d/e I Mb
 - EN 60079-0 2009 /60079-1 2007/ 60079-31 2009
- Protection class: IP66 / IP68 (EN 60529)
- Application area:
 - Zones 1, 2, 21 and 22
 - Group Gas IIA, IIB and IIC

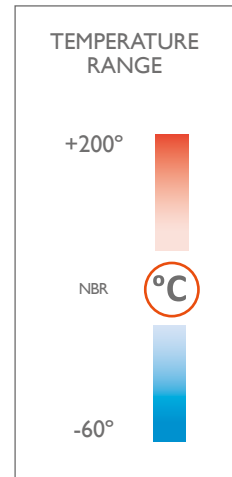

Reference configuration. Examples: MVAD.M40N1.S6 or MVAD.NI/4M16.ON

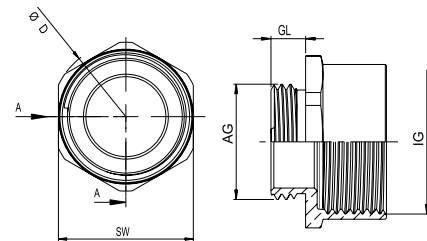
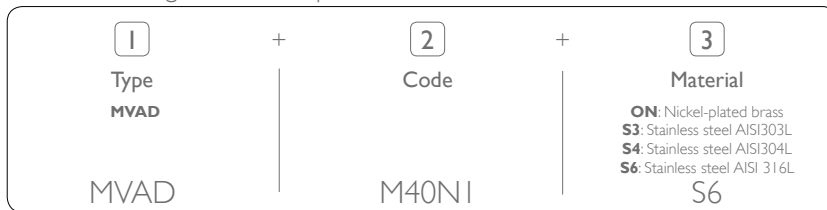

REFERENCES ADAPTER EX D/E

ADAPTER	CODE	SIZE AG (M)	SIZE IG (F)	GL (MIN. mm)	H (mm)	SW (mm)
MVAD	M12N1/4	M12x1,5	NPT1/4"	15	33,5	18
MVAD	M12N3/8	M12x1,5	NPT3/8"	15	33,5	20
MVAD	M16N3/8	M16x1,5	NPT3/8"	15	33,5	20
MVAD	M16N1/2	M16x1,5	NPT1/2"	15	34	25
MVAD	M20N1/2	M20x1,5	NPT1/2"	15	34	25
MVAD	M20N3/4	M20x1,5	NPT3/4"	15	34	30
MVAD	M25N3/4	M25x1,5	NPT3/4"	15	34	30
MVAD	M25N1	M25x1,5	NPT1"	15	34	36
MVAD	M32N1	M32x1,5	NPT1"	15	34	36
MVAD	M32N1 1/4	M32x1,5	NPT1 1/4"	15	37	45
MVAD	M40N1 1/4	M40x1,5	NPT1 1/4"	18	40	45
MVAD	M40N1 1/2	M40x1,5	NPT1 1/2"	18	40	55
MVAD	M50N1 1/2	M50x1,5	NPT1 1/2"	18	40	55
MVAD	M50N2	M50x1,5	NPT2"	18	40,5	65
MVAD	M63N2	M63x1,5	NPT2"	18	40,5	70
MVAD	M63N2 1/2	M63x1,5	NPT2 1/2"	18	40,5	80
MVAD	M75N2 1/2	M75x1,5	NPT2 1/2"	18	40,5	80
MVAD	M75N3	M75x1,5	NPT3"	18	43,5	95
MVAD	M90N3	M90x1,5	NPT3"	21	47	95
MVAD	M90N4	M90x1,5	NPT4"	21	47	120
MVAD	M110N4	M110x1,5	NPT4"	21	47	120
MVAD	NI/4M12	NPT1/4"	M12x1,5	15	33	18
MVAD	NI/4M16	NPT1/4"	M16x1,5	15	33,5	22
MVAD	N3/8M16	NPT3/8"	M16x1,5	15	33,5	22
MVAD	N3/8M20	NPT3/8"	M20x1,5	15	34	25
MVAD	NI/2M20	NPT1/2"	M20x1,5	15	34	25
MVAD	NI/2M25	NPT1/2"	M25x1,5	15	34	30
MVAD	N3/4M25	NPT3/4"	M25x1,5	15	34	30
MVAD	N3/4M32	NPT3/4"	M32x1,5	15	34	36
MVAD	N1M32	NPT1"	M32x1,5	15	34	36
MVAD	N1M40	NPT1"	M40x1,5	15	37	45
MVAD	NI 1/4M40	NPT1 1/4"	M40x1,5	18	40	45
MVAD	NI 1/4M50	NPT1 1/4"	M50x1,5	18	40	55
MVAD	NI 1/2M50	NPT1 1/2"	M50x1,5	18	40	55
MVAD	NI 1/2M63	NPT1 1/2"	M63x1,5	18	40,5	70
MVAD	N2M63	NPT2"	M63x1,5	18	40,5	70
MVAD	N2M75	NPT2"	M75x1,5	18	40,5	80
MVAD	N2 1/2M75	NPT2 1/2"	M75x1,5	18	40,5	80
MVAD	N2 1/2M90	NPT2 1/2"	M90x1,5	18	44	95
MVAD	N3M90	NPT3"	M90x1,5	21	47	95
MVAD	N3M110	NPT3"	M110x1,5	21	47	115
MVAD	N4M110	NPT4"	M110x1,5	21	47	120

Available upon request

REDUCERS EX D/E IP66 - IP68

REDUCER EX D/E IP66 - IP68

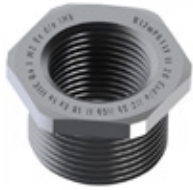

- Material: Nickel-plated brass, stainless steel AISI303L, stainless steel AISI304L and stainless steel AISI316L
- O-ring: NBR
- Normative and marking:
 - I I 2G Exd/e IIC Gb II I D Ex ta IIC Da I M2 Ex d/e I Mb
 - EN 60079-0 2009 /60079-1 2007/ 60079-3 I 2009
- Protection class: IP66 / IP68 (EN 60529)
- Application area: Zones 1, 2, 21 and 22 and Group Gas IIA, IIB and IIC
- Temperature range: -60°C to +200°C

Reference configuration. Examples: MVAD1.M16M12.S6 or MVAD1.N3/8N1/4.ON

1	+	2	+	3
Type		Code		Material
MVAD1		M16M12		ON: Nickel-plated brass S3: Stainless steel AISI303L S4: Stainless steel AISI304L S6: Stainless steel AISI 316L
MVAD1		M16M12		S6

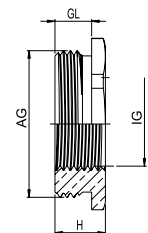
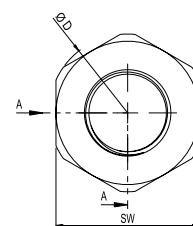

REFERENCES REDUCER EX D/E

REDUCER	CODE	SIZE AG (M)	SIZE IG (F)	GL (MIN. mm)	H (mm)	SW (mm)
MVAD1	M16M12	M16x1,5	M12x1,5	15	19	22
MVAD1	M20M12	M20x1,5	M12x1,5	15	19	25
MVAD1	M20M16	M20x1,5	M16x1,5	15	19	25
MVAD1	M25M16	M25x1,5	M16x1,5	15	19	30
MVAD1	M25M20	M25x1,5	M20x1,5	15	19	30
MVAD1	M32M20	M32x1,5	M20x1,5	15	19	36
MVAD1	M32M25	M32x1,5	M25x1,5	15	19	36
MVAD1	M40M25	M40x1,5	M25x1,5	18	22	45
MVAD1	M40M32	M40x1,5	M32x1,5	18	22	45
MVAD1	M50M32	M50x1,5	M32x1,5	18	23	55
MVAD1	M50M40	M50x1,5	M40x1,5	18	23	55
MVAD1	M63M40	M63x1,5	M40x1,5	18	23	70
MVAD1	M63M50	M63x1,5	M50x1,5	18	23	70
MVAD1	M75M50	M75x1,5	M50x1,5	18	24	85
MVAD1	M75M63	M75x1,5	M63x1,5	18	24	85
MVAD1	M90M63	M90x1,5	M63x1,5	21	29	100
MVAD1	M90M75	M90x1,5	M75x1,5	21	29	100
MVAD1	M110M75	M110x1,5	M75x1,5	21	31	120
MVAD1	M110M90	M110x1,5	M90x1,5	21	31	120
MVAD1	N3/8N1/4	NPT3/8"	NPT1/4"	15	19	22
MVAD1	N1/2N1/4	NPT1/2"	NPT1/4"	15	19	25
MVAD1	N1/2N3/8	NPT1/2"	NPT3/8"	15	19	25
MVAD1	N3/4N3/8	NPT3/4"	NPT3/8"	15	19	30
MVAD1	N3/4N1/2	NPT3/4"	NPT1/2"	15	19	30
MVAD1	N1N1/2	NPT1"	NPT1/2"	15	19	36
MVAD1	N1N3/4	NPT1"	NPT3/4"	15	19	36
MVAD1	N11/4N1/2	NPT1 1/4"	NPT1/2"	18	22	45
MVAD1	N11/4N3/4	NPT1 1/4"	NPT3/4"	18	22	45
MVAD1	N11/4N1	NPT1 1/4"	NPT1"	18	22	45
MVAD1	N11/2N1/2	NPT1 1/2"	NPT1/2"	18	23	55
MVAD1	N11/2N3/4	NPT1 1/2"	NPT3/4"	18	23	55
MVAD1	N11/2N1	NPT1 1/2"	NPT1"	18	23	55
MVAD1	N11/2N11/4	NPT1 1/2"	NPT1 1/4"	18	23	55
MVAD1	N2N11/4	NPT2"	NPT1 1/4"	18	23	65
MVAD1	N2N11/2	NPT2"	NPT1 1/2"	18	23	65
MVAD1	N21/2N11/2	NPT2 1/2"	NPT1 1/2"	18	24	75
MVAD1	N21/2N2	NPT2 1/2"	NPT2"	18	24	75
MVAD1	N3N2	NPT3"	NPT2"	21	29	95
MVAD1	N3N21/2	NPT3"	NPT2 1/2"	21	29	95
MVAD1	N4N21/2	NPT4"	NPT2 1/2"	21	31	120
MVAD1	N4N3	NPT4"	NPT3"	21	31	120

Available upon request

ENLARGER - REDUCER EX D/E IP66 - IP68



- Material: Nickel-plated brass, stainless steel AISI303L, stainless steel AISI304L and stainless steel AISI316L
- O-ring: NBR
- Normative and marking:
 - II 2G Exd/e IIC Gb II ID Ex ta IIIC Da I M2 Ex d/e I Mb
 - EN 60079-0 2009 /60079-1 2007/ 60079-31 2009
- Protection class: IP66 / IP68 (EN 60529)
- Application area: Zones 1, 2, 21 and 22 and Group Gas IIA, IIB and IIC
- Temperature range: -60°C to +200°C

Reference configuration. Examples: MVAD.MI2MI6.S6 or MVAD.NI1/4N3/8.ON

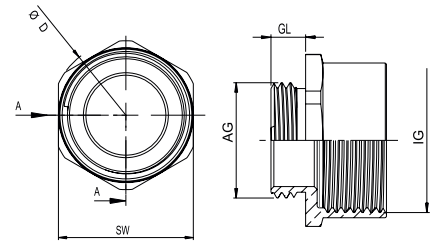

REFERENCES ENLARGER - REDUCER EX D/E						
ENLARGER - REDUCER	CODE	SIZE AG (M)	SIZE IG (F)	GL (MIN. mm)	H (mm)	SW (mm)
MVAD	MI2MI2	M12x1,5	M12x1,5	15	33,5	18
MVAD	MI2MI6	M12x1,5	M16x1,5	15	33,5	22
MVAD	M16MI6	M16x1,5	M16x1,5	15	33,5	22
MVAD	MI2M20	M12x1,5	M20x1,5	15	34	25
MVAD	M16M20	M16x1,5	M20x1,5	15	34	25
MVAD	M20M20	M20x1,5	M20x1,5	15	34	25
MVAD	M16M25	M16x1,5	M25x1,5	15	34	30
MVAD	M20M25	M20x1,5	M25x1,5	15	34	30
MVAD	M25M25	M25x1,5	M25x1,5	15	34	30
MVAD	M20M32	M20x1,5	M32x1,5	15	34	36
MVAD	M25M32	M25x1,5	M32x1,5	15	34	36
MVAD	M32M32	M32x1,5	M32x1,5	15	34	36
MVAD	M25M40	M25x1,5	M40x1,5	15	37	45
MVAD	M32M40	M32x1,5	M40x1,5	15	37	45
MVAD	M40M40	M40x1,5	M40x1,5	18	40	45
MVAD	M32M50	M32x1,5	M50x1,5	15	37	55
MVAD	M40M50	M40x1,5	M50x1,5	18	40	55
MVAD	M50M50	M50x1,5	M50x1,5	18	40	55
MVAD	M50M63	M50x1,5	M63x1,5	18	40,5	70
MVAD	M63M63	M63x1,5	M63x1,5	18	40,5	70
MVAD	M63M75	M63x1,5	M75x1,5	18	40,5	80
MVAD	M75M75	M75x1,5	M75x1,5	18	40,5	85
MVAD	M75M90	M75x1,5	M90x1,5	18	43,5	95
MVAD	M90M90	M90x1,5	M90x1,5	21	47	95
MVAD	M90M110	M90x1,5	M110x1,5	21	47	115
MVAD	M110M110	M110x1,5	M110x1,5	21	47	120
MVAD	NI1/4NI1/4	NPT1/4"	NPT1/4"	15	33	18
MVAD	NI1/4N3/8	NPT1/4"	NPT3/8"	15	33,5	20
MVAD	N3/8N3/8	NPT3/8"	NPT3/8"	15	33,5	20
MVAD	N3/8NI1/2	NPT3/8"	NPT1/2"	15	34	25
MVAD	NI1/2NI1/2	NPT1/2"	NPT1/2"	15	34	25
MVAD	NI1/2N3/4	NPT1/2"	NPT3/4"	15	34	30
MVAD	N3/4N3/4	NPT3/4"	NPT3/4"	15	34	32
MVAD	N3/4NI1	NPT3/4"	NPT1"	15	34	36
MVAD	NI1NI1	NPT1"	NPT1"	15	34	36
MVAD	NI1NI1/4	NPT1"	NPT1 1/4"	15	37	45
MVAD	NI1/4NI11/4	NPT1 1/4"	NPT1 1/4"	18	40,5	45
MVAD	NI1/4NI11/2	NPT1 1/4"	NPT1 1/2"	18	40,5	55
MVAD	NI1/2NI11/2	NPT1 1/2"	NPT1 1/2"	18	40,5	55
MVAD	NI11/2N2	NPT1 1/2"	NPT2"	18	40,5	65
MVAD	N2N2	NPT2"	NPT2"	18	40,5	65
MVAD	N2N21/2	NPT2"	NPT2 1/2"	18	40,5	80
MVAD	N21/2N21/2	NPT2 1/2"	NPT2 1/2"	18	40,5	80
MVAD	N21/2N3	NPT2 1/2"	NPT3"	18	43,5	95
MVAD	N3N3	NPT3"	NPT3"	21	47	95
MVAD	N3N4	NPT3"	NPT4"	21	47	120
MVAD	N4N4	NPT4"	NPT4"	21	47	120

Available upon request

VALVES IP66

AUTOMATIC BREATHER AND DRAINAGE HAZARDOUS AREA VALVES ATEX IP66



- Valves are suitable to be used on increased safety, intrinsically safety or watertight enclosures to facilitate the elimination of condensation or vapors developed inside. We recommended minimum 2 units per enclosure
- Material: stainless steel AISI316 o Nickel-plated brass
- Internal filter: stainless steel
- Gaskets: silicone
- Internal seeger: stainless steel
- Normative and marking:
 - o II 2GD Ex eb IIC Gb
 - o Ex tb IIIC Db
 - o EN 60079-14
 - o IEC 60079-0:2011 / 60079-7:2015 / IEC 60079-31:2013
 - o Directive 2014/34/UE
 - o EN 60079-0:2012 / 60079-7:2015 / 60079-31:2014
- Protection class: IP66

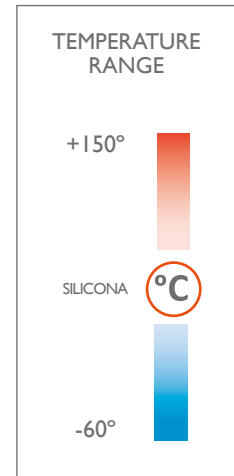

HOW VALVE WORKS

IP66 Waterproof Anti-condensation valve to facilitate air circulation by convection inside the modules, preventing the formation of condensation. Pressure differences in enclosures with a high degree of protection from moisture and dust, are the result of fluctuations in internal and external temperature. If negative pressure or vacuum dust and moisture can be absorbed by the sealed doors and can enter the hazardous area enclosure. Because moisture can not escape, condensation can occur. Allows to regulate the pressure to prevent condensation following an increase in the internal temperature.

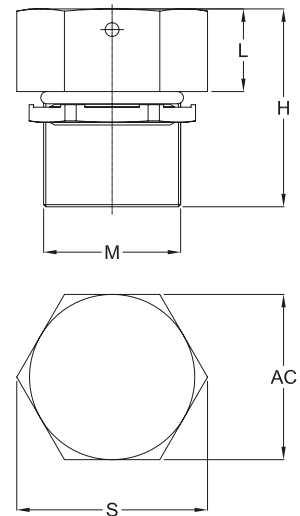

REFERENCES AUTOMATIC BREATHER AND DRAINAGE HAZARDOUS AREA VALVES ATEX

REFERENCES	USE	MATERIAL	DIMENSIONS (mm)					MINIMUM
			M	AC	S	H	L	
MVVAC04B.M20.S6.Ex	Breather	Stainless steel	M20x1,5	24	28	26	12	20
MVVAC04D.M20.S6.Ex	Drainage		M20x1,5	24	28	26	12	
MVVAC04B.M20.ON.Ex	Breather	Nickel-plated brass	M20x1,5	24	28	26	12	50
MVVAC04D.M20.ON.Ex	Drainage		M20x1,5	24	28	26	12	

ACCESSORIES

SHROUD IP66 - IP68



- Material:
 - TPV
 - PVC
 - LSF
- Protection class: IP66 / IP68 (EN 60529)
- Temperature range: -20°C to +80°C

Reference configuration. Example: MVSHR16LSF

1	+	2	+	3
Type		Size		Material
MVSHR		16		TPV:TPV PVC:PVC LSF:LSF
MVSHR		16		LSF

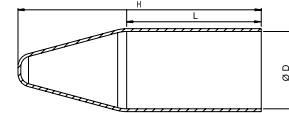
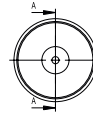

REFERENCES SHROUD				
SHROUD	SIZE	ØD (mm)	H (mm)	L (mm)
MVSHR	16	25	100	60
MVSHR	20	32	110	65
MVSHR	25	41	130	70
MVSHR	32	49	145	77
MVSHR	40	60	170	85
MVSHR	50S	65	155	86
MVSHR	50	75	175	92
MVSHR	63S	81	180	92
MVSHR	63	86	180	92
MVSHR	75S	100	220	115
MVSHR	75	110	220	115

Available upon request

EARTH TAG



- Material:
 - Nickel-plated brass
 - Stainless steel AISI303L
- Temperature range: -40°C to +100°C

Reference configuration. Example: MVTTI6ON

1	+	2	+	3
Type		Size		Material
MVTT		16		ON: Nickel-plated brass S3: Stainless steel AISI303L
MVTT		16		ON

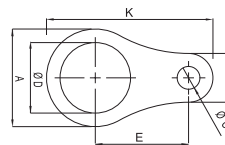

REFERENCES EARTH TAG								
EARTH TAG	SIZE	A (mm)	ØD (mm)	ØC (mm)	F (mm)	K (mm)	E (mm)	T (mm)
MVTT	16	25,4	16,5	6,5	12,5	49	30	1
MVTT	20	27	20,5	6,5	10,2	51,6	33	1
MVTT	25	35	25,5	6,5	13,5	60	35,5	1
MVTT	32	45	32,5	10,5	22,5	76,75	43	1
MVTT	40	53,5	40,5	10,5	23,6	83,5	45	1
MVTT	50	65	50,5	10,5	29,5	105,25	58	1
MVTT	63	82	63,5	10,5	29,5	122,75	67	1
MVTT	75	96	75,5	6,5	24	-	73	1,5
MVTT	90	114	90,5	6,5	37	-	86	1,5

Available upon request

DELVALLE OFFERS OTHER SOLUTIONS ATEX & IECEx

➔ [CLICK HERE AND DISCOVER ALL SOLUTIONS](#)

ATEX TERMINAL BOXES TERBOX SERIES



EX LOCAL CONTROL & DISTRIBUTION BOXES CONTREX SERIES



PLUG AND SOCKET BOXES CONNEX SERIES



FLAMEPROOF CONNECTION BOXES EJB SERIES



EX LIGHTING FIXTURE ATEX



PRESSURIZED ENCLOSURE EX P

PEPPEX SERIES





Contact us at:
atex@atexdelvalle.com
We'll give a solution as

DELVALLE OFFERS OTHER SOLUTIONS ATEX & IECEx

[CLICK HERE AND DISCOVER ALL SOLUTIONS](#)

EX CABLE GLANDS ATEX & IECEx



MOTOR AND SWITCH MACHINES ATEX & IECEx



EX PUSH BUTTON STATION CONTREX SERIES



INDUSTRIAL WORKSTATIONS & HMI'S ATEX



EX 19" RACK ATEX



HAZARDOUS WIRELESS & ANTENNA SYSTEMS ATEX





FLEXIBLE SOLUTIONS ATEX & IECEX



Paso del Prao, 6. 01320 Oyón (Álava). Spain
Telf. +34 945 601 381
www.atexdelvalle.com - atex@atexdelvalle.com

Contact us, we will be available at any time